

P.C.B. LAYOUT(S=3:1)

NOTES:

1. Rating: 150V 8A
2. Insulation Withstands Voltage:  
AC 1600V at 1 minute
3. Insulation Resistance:  
500MΩ or more at DC500V
4. Using Temperature Range:  
-40°C ~ +105°C
5. RoHS Compliance

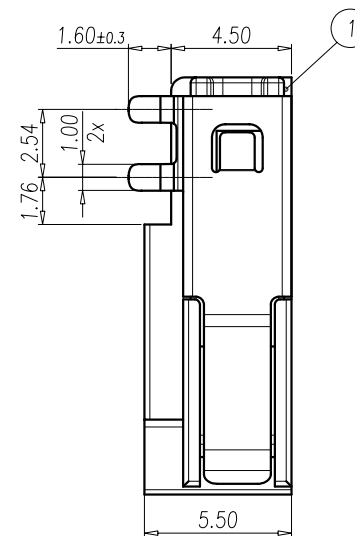
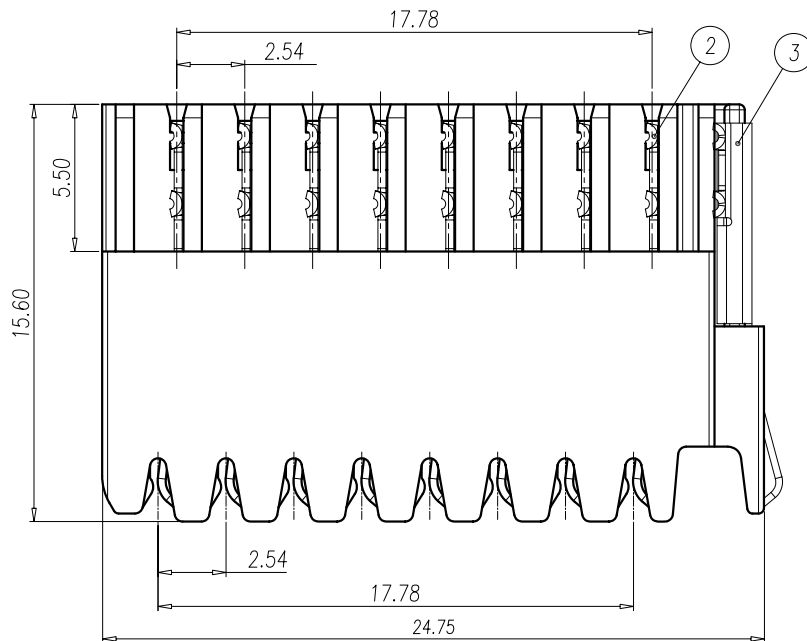

Normal Geometric Tolerancing				
—	//	≡	⊥	
0 to 100	0.2	0.3	0 to 10	0.2
over 100 to 150	0.3		over 10	0.3
over 150	0.5			
Total Pitch Tolerances		Normal Dimension Tolerances		
0~30	±0.20	0~30	±0.25	
over 30~53	±0.25	over 30~53	±0.30	
over 53~70	±0.30	over 53~70	±0.35	
over 70~90	±0.35	over 70~90	±0.44	
over 90~115	±0.44	over 90~115	±0.55	
over 115~150	±0.55	over 115~150	±0.70	
over 150~200	±0.70	over 150~200	±0.85	
over 200~250	±0.85	over 200~250	±1.00	
over 250~320	±1.00	over 250~320	±1.20	

3	SOLDER PIN	COPPER ALLOY	Gold Plated
2	SOLDER PIN	COPPER ALLOY	Gold Plated
1	HOUSING	PA	UL94-V0 BLACK
ITEM	NAME OF PART	MATERIAL	NOTES

DWG.	ZW	DATE	2015.03.24	UNITS	MM	SHEET/OF	1 / 1
CHK.		DATE		SCALE	5:1 ( : )		
APP.		DATE		NAME		BS-100	
<b>DINKLE</b> ENTERPRISE CO.,LTD				DWG NO.	SP-03-BS100000		

△	REV.	CONTENT	NAME	DATE